

Harlequin Liberty™

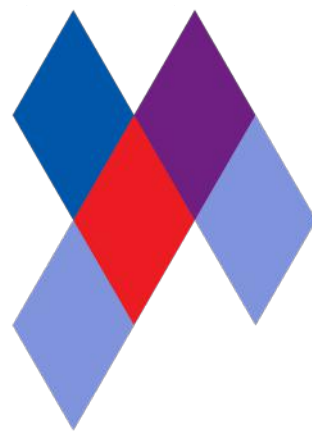

Harlequin Liberty is a lacquered birch plywood sprung floor panel system featuring shock dampening dual-density elastomer pads. The panels join using a rounded tongue and groove and are secured in place using our proprietary 'one turn of the key' latch and lock mechanism.

Performance surface: Harlequin Liberty can be used with a variety of performance surface options from the Harlequin range of performance vinyls and solid or engineered wood finishes. Edge trims and ramps are available if required. For easy storage and transportation please see Harlequin's panel cart.

Installation: Harlequin Liberty is designed for both permanent or portable installation. The panels are laid in a 'brickwork fashion' onto the sub-floor so that cross joints do not coincide. This provides consistent shock dampening across the floor and offers the same feel and energy return to one or several dancers.

Specification Guide

Permanent or Portable	Both
Panel Size	2m x 1m & 1m x 1m
Minimum Floor Thickness (before inclusion of chosen surface)	37mm
Weight	12.5kg/m ² (Without surface)
Testing Standard	BS EN 14904:2006
Shock Absorption	67%
Vertical Deformation	4.1mm
Area Deflection	12.8%
Rolling Load	>1500 N
Testing Standard	BS EN 1991-1-1:2002
Point Load	>3.60kN
Uniform Distributed Load	>10.00kN
Fire Rating	Bfls 1 to EN 13501
Impact Generated Sound Level within room (Lw)	104.20dB
Thermal Resistance - R Value	1.52 m ² K/W
Thermal Insulation - U Value	0.658 W/m ² K
Category of Use	A4
VOC Emissions	<0.10 mg/m ³
Warranty	10 years if installed by Harlequin 5 years if installed externally
Installation	Installed by Harlequin or the customer
Underfloor Heating	Suitable for use with underfloor heating

Harlequin Liberty with selected Harlequin vinyl performance floor

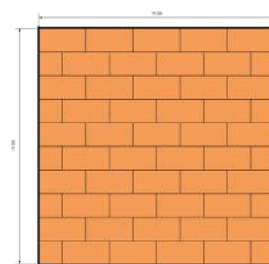

Harlequin Liberty Panels are laid in a 'Brickwork Fashion'



Harlequin's 'latch and lock' system



HARLEQUIN
www.harlequinfloors.com

LONDON ♦ LUXEMBOURG ♦ BERLIN ♦ MADRID ♦ PARIS ♦ LIEGE ♦ PHILADELPHIA ♦ LOS ANGELES ♦ FORT WORTH ♦ SYDNEY ♦ HONG KONG ♦ TOKYO

Harlequin Liberty Accessories

The Harlequin Liberty sprung floor panel system has a range of accessories that complement the floor both practically and aesthetically. **Ramps, mini ramps and edge trims** can be used around the perimeter of the floor area to enable easy access on to the floor, eliminate trip hazards and hide the lock and latch mechanism. The accessories are made from birch plywood that is painted black, they come in left and right-handed sections with corresponding latches and receivers. The full-size ramps are DDA compliant.

Ramps:

Specification Guide

Width	540mm
Length	1m & 2m
Height	37mm



Mini Ramps:

Specification Guide

Width	200mm
Length	1m & 2m
Height	37mm



Edge Trims & Corner Pieces:

Specification Guide

Width	205mm
Length	540mm
Height	37mm



Corner Pieces

Specification Guide

Width	65mm
Length	1m & 2m
Height	37mm



Edge Trim



Harlequin Liberty Panel Cart: The Harlequin Liberty panel cart enables the safe storage and handling of 22 Harlequin Liberty sprung floor panels. The cart is easy to manoeuvre with non-marking brake wheels.

- Stores up to 22 full size (2m x 1m) Harlequin Liberty sprung floor panels
- Constructed from black scratch-resistant, powder-coated steel
- Fitted with four heavy-duty swivel castors with breaks and non-marking polyamide wheels
- Forklift pockets for side lifting

Specification Guide

Width	1270mm
Length	2025mm
Height (For Panels)	993mm
Total Height	1211mm
Weight	Approximately 112kg



Latch Key:

The panels join using a rounded tongue and groove and are secured in place using our proprietary 'one turn of the key' latch and lock mechanism.

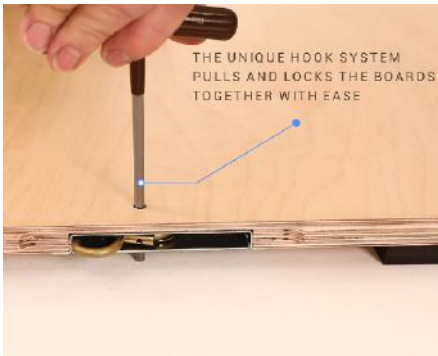



Who dances
on Harlequin
Liberty™

**SCOTTISH
BALLET**



**2FACED
DANCE**



Athelhampton



Académie
Franco-Américaine
de Danse de Paris

**TRINITY
MUSIC LABAN
DANCE**

ARCO|INTER|ORS



If you would like further information or advice please contact us on
+852 2541 666 or hksales@harlequinfloors.com

The Company reserves the right to make any variation in design or construction of the material described. Harlequin ® is a registered trademark of British Harlequin plc. © Harlequin Floors 11/2023



Harlequin Liberty Panels

American Academy of Dance in Paris